

MKIV Universal Hopper Service Manual



This document is the private unpublished property of Money Controls Ltd and may not be reproduced in part or in total by any means, electronic or otherwise, without the written permission of Money Controls Ltd. Money Controls Ltd does not accept liability for any errors or omissions contained within this document. Money Controls Ltd shall not incur any penalties arising out of the adherence to, interpretation of, or reliance on, this standard. Money Controls Ltd will provide full support for this product when used as described within this document. Use in applications not covered or outside the scope of this document may not be supported. Money Controls Ltd. reserves the right to amend, improve or change the product referred to within this document or the document itself at any time.

Contents

1. Diary of Changes	3
2. Coin Box Removal.....	4
3. Low Level Sense Plate Removal	6
4. High/Top Level Sense Plate Replacement.....	7
5. Exit Window Replacement.....	9
6. Logic Board Replacement	10
7. End Plate Removal	11
8. Track Plate Removal	12
9. Track Plate Assembly.....	13
10. Track Plate Replacement	14
11. Final Drive Gear Replacement.....	15
12. Gear Box Cover Replacement	16
13. Gear Box Assembly.....	17
14. Motor Replacement	18
15. Loom Replacement	19
16. Coin Box Assembly.....	20

Figures

Figure 1: Low level sensor crimp positions	4
Figure 2: Coin box screw positions.....	4
Figure 3: Coin box removal	5
Figure 4: Low level stud assembly.....	6
Figure 5: Low level sense plates position	6
Figure 6: High & Top level studs.....	7
Figure 7: High & Top level sense positions	8
Figure 8: Exit window position	9
Figure 9: Logic Board position.....	10
Figure 10: End Plate screw positions	11
Figure 11: Elevator track position	12
Figure 12: Track Plate dismantling	13
Figure 13: Track Plate assembly	13
Figure 14: Track Plate positioning	14
Figure 15: Final Drive Gear position.....	15
Figure 16: Gear Box Cover position	16
Figure 17: Gear Box Assembly.....	17
Figure 18: Motor screw positions.....	18
Figure 19: Stirrer position	20
Figure 20: Coin Box Assembly 1	20
Figure 21: Coin Box Assembly 2	21
Figure 22: Coin Box Assembly 3	21

1. Diary of Changes

Issue 1.0.....8th September 2002
➤ First issue in new format

2. Coin Box Removal

1. Place the hopper in front of you as shown, (looking at the outside of the 'Coin Box').
Refer to Figure 1.
2. Remove the 2 locking nuts which hold the 'Low Level Sense Plate' wires to the studs.
3. Remove the crimp & wire from the studs.

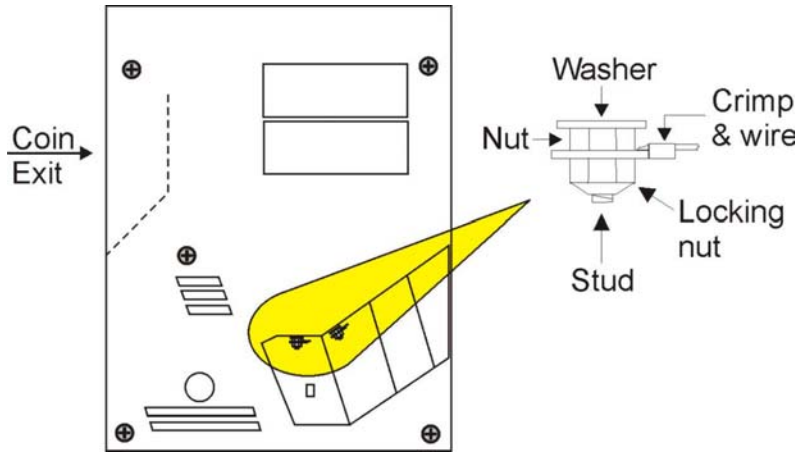

Figure 1: Low level sensor crimp positions

4. If other sense plates are used, i.e. High/Top, then refer to section 4 otherwise continue.
Refer to Figure 2.
5. Remove the 5 screws indicated (A), which hold the 'Coin Box' to the 'Centre Plate'.

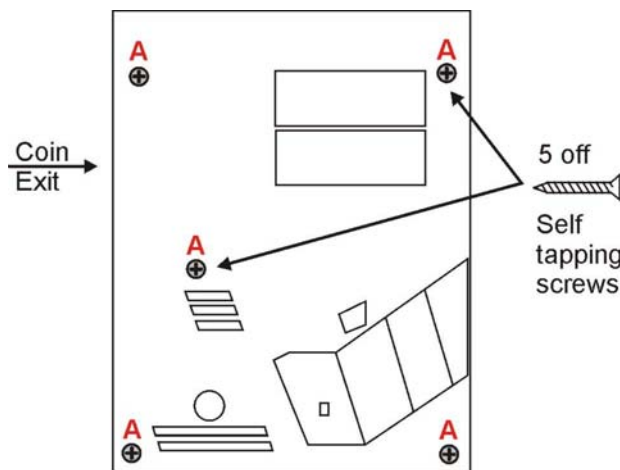

Figure 2: Coin box screw positions

CONFIDENTIAL

Not to be disclosed without prior written permission from Money Controls

Refer to Figure 3.

6. Gently lift the 'Coin Box' away from the rest of the hopper.

NOTE:- The 'Logic Board' & 'Stirrer' are located in the 'Coin Box'.

7. As the 'Coin Box' is being removed, carefully slide the 'Logic Board' out. The stirrer may stay with the 'Coin Box' or fall onto the centre plate.

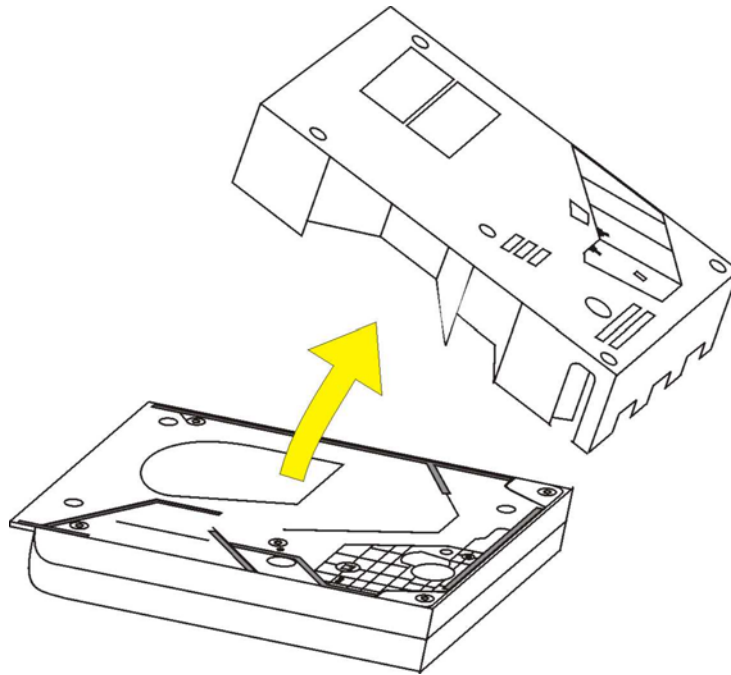

Figure 3: Coin box removal

ACCESS IS NOW AVAILABLE TO THE 'LOW LEVEL' SENSE PLATES, THE MAIN PCB, THE EXIT WINDOW, THE MOTOR TERMINALS & PART OF THE WIRING LOOM.

3. Low Level Sense Plate Removal

1. First, remove the 'Coin Box', see section 2.

Refer to Figure 4.

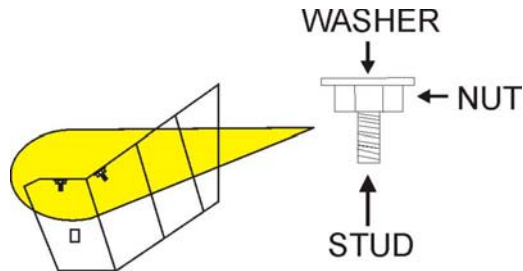
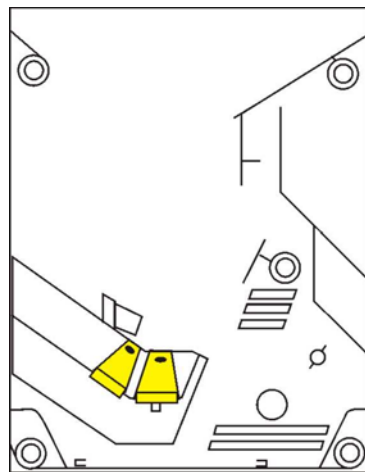

Figure 4: Low level stud assembly

2. Remove the 2 remaining nuts & washers from the sense plate studs.
3. Remove the studs.

Refer to Figure 5.

4. Slide the sense plates away from the 'Coin Box' & remove.



THIS SHOWS THE POSITION OF THE TWO LOW LEVEL SENSE PLATES, LOOKING AT THE INSIDE OF THE 'COIN BOX'.

Figure 5: Low level sense plates position

5. To re-assemble, follow the above steps in reverse.

CONFIDENTIAL

Not to be disclosed without prior written permission from Money Controls

Page 6 of 22

4. High/Top Level Sense Plate Replacement

The 'High' & 'Top' level sense plates can be accessed without removing the 'Coin Box'.

Refer to Figure 6.

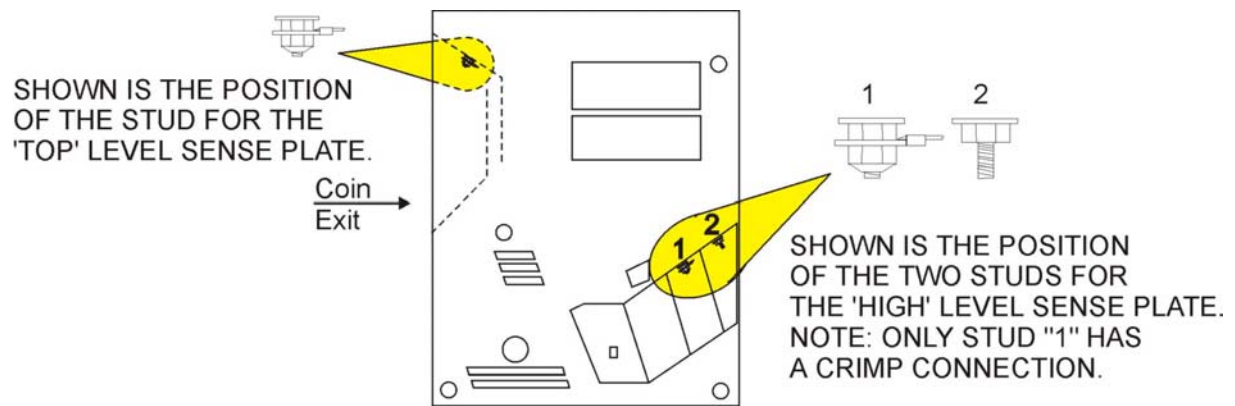

Figure 6: High & Top level studs

Irrespective of which plate is fitted :-

1. Remove the locking nut, (where fitted).
2. Remove the sense plate crimp & wire.
3. Remove the remaining nuts & washers.
4. Remove the stud/s.

The sense plate can now be removed.

Refer to Figure 7.

5. Place the relevant sense plate in position.

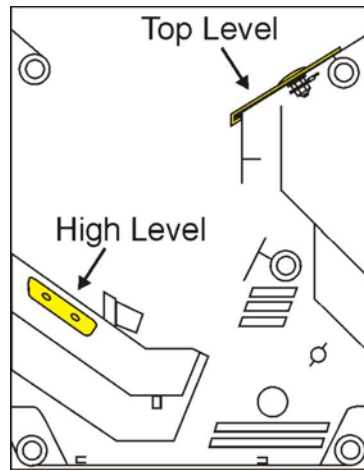

SHOWN IS THE SHAPE
& POSITION OF THE 'TOP'
& 'HIGH' LEVEL SENSE
PLATES, LOOKING AT THE
INSIDE OF THE 'COIN BOX'
ON IT'S OWN.

Figure 7: High & Top level sense positions

6. To re-assemble, follow steps 1 to 4, above, in reverse.

5. Exit Window Replacement

1. First, remove the 'Coin Box', see section 2.

This will then enable access to the 'Exit Window'

2. Unscrew & remove the 2 fixing screws. Figure 8.
3. Remove the 'Exit Window' from the 'Centre Plate'.
4. Unclip & remove the 10 way ribbon cable header.

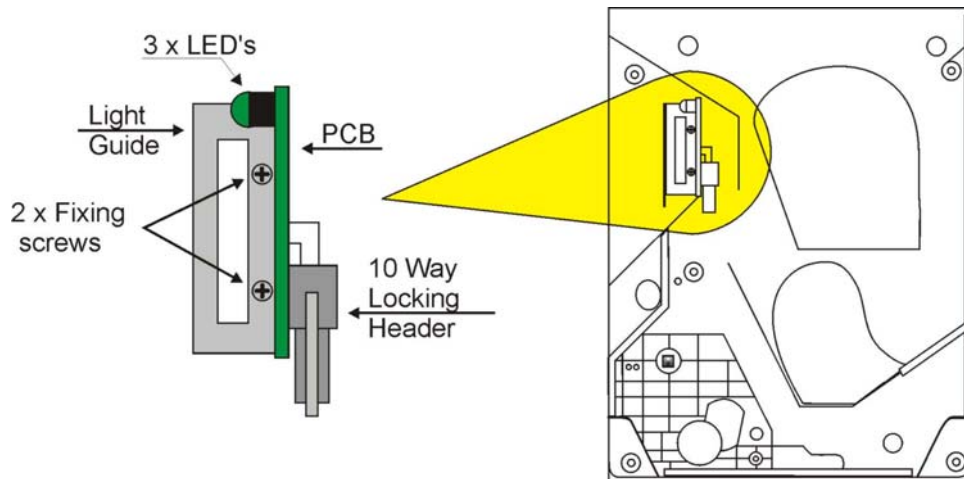

Figure 8: Exit window position

5. To re-assemble, follow the above steps in reverse.

6. Logic Board Replacement

1. First, remove the 'Coin Box', section 2.

This will then enable access to the 'Logic Board'.

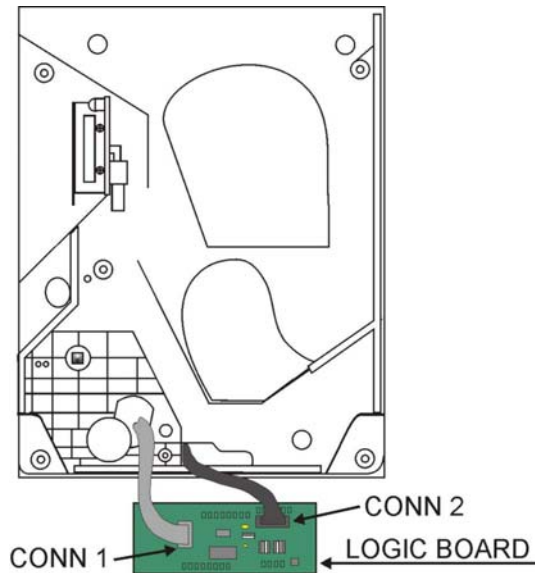

Figure 9: Logic Board position

10 way ribbon IDC socket (CONN 1).

2. Move the two ejector arms at right angles to & away from the connector, if fitted.
This should release the socket from the header.
Clasping the connector between thumb & forefinger, pull away from pin header.

14 way crimp socket (CONN 2).

3. Gently, un-clip the "friction lock" from the connector housing.
Clasping the connector between thumb & forefinger, pull away from pin header.

The Logic Board is now released.

4. To re-assemble, follow the above steps in reverse.

CONFIDENTIAL

Not to be disclosed without prior written permission from Money Controls

Page 10 of 22

7. End Plate Removal

1. Place the hopper in front of you as shown, (looking at the outside of the 'End Plate').
Refer to Figure 10.
2. Remove the 9 screws indicated (B), which hold the 'End Plate' to the 'Centre Plate'.
3. Locate the position of the 'Connector Blanking Plate'.
4. Holding the 'Connector Blanking Plate' gently lift the 'End Plate' away from the rest of the hopper.

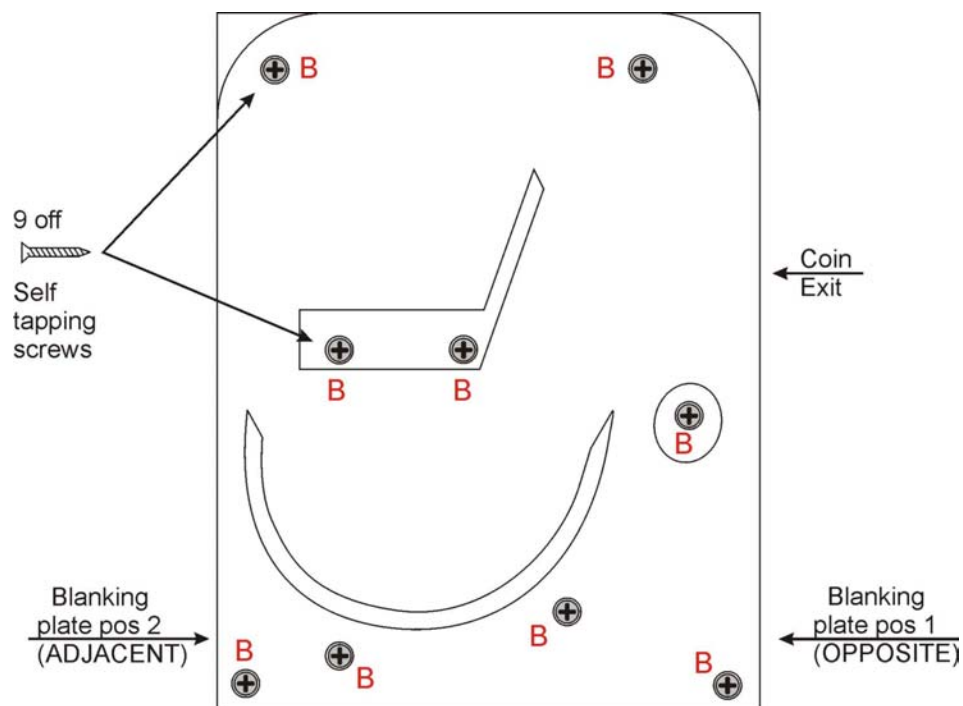

Figure 10: End Plate screw positions

5. To re-assemble, follow the above steps in reverse.

CONFIDENTIAL

Not to be disclosed without prior written permission from Money Controls

Page 11 of 22

8. Track Plate Removal

1. First, remove the 'End Plate', section 7.

Refer to Figure 11.

2. The 'Elevator Track' & 'Final Drive Gear' can now be removed by lifting up & away from the 'Centre Plate'.

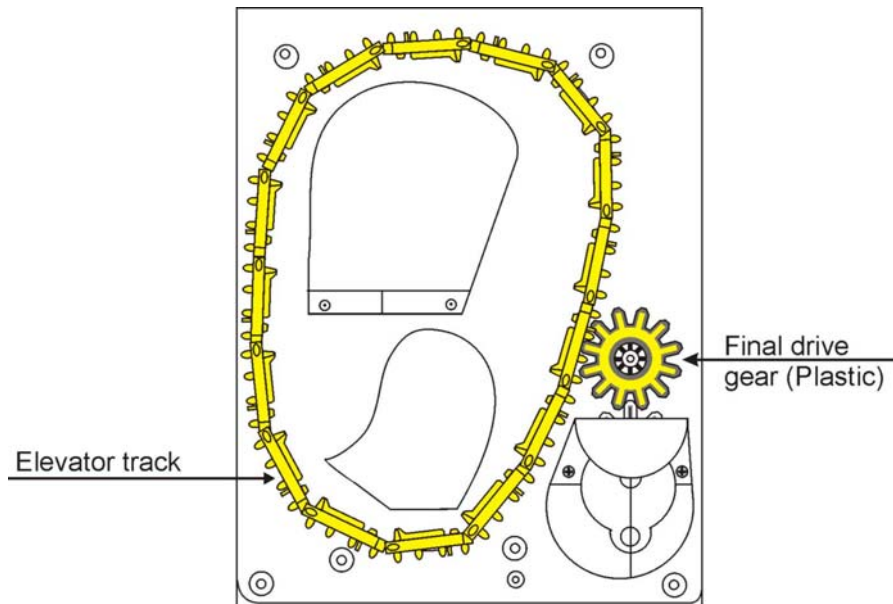

Figure 11: Elevator track position

9. Track Plate Assembly

The following 3 sketches show how to take the 'Track Plate' apart.

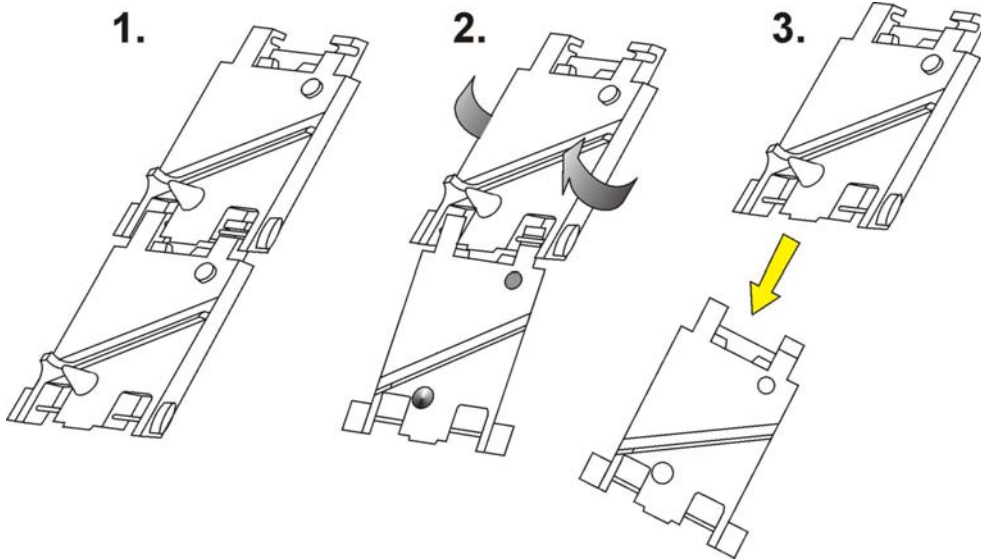

Figure 12: Track Plate dismantling

The following 3 sketches show how to assemble the 'Track Plate'.

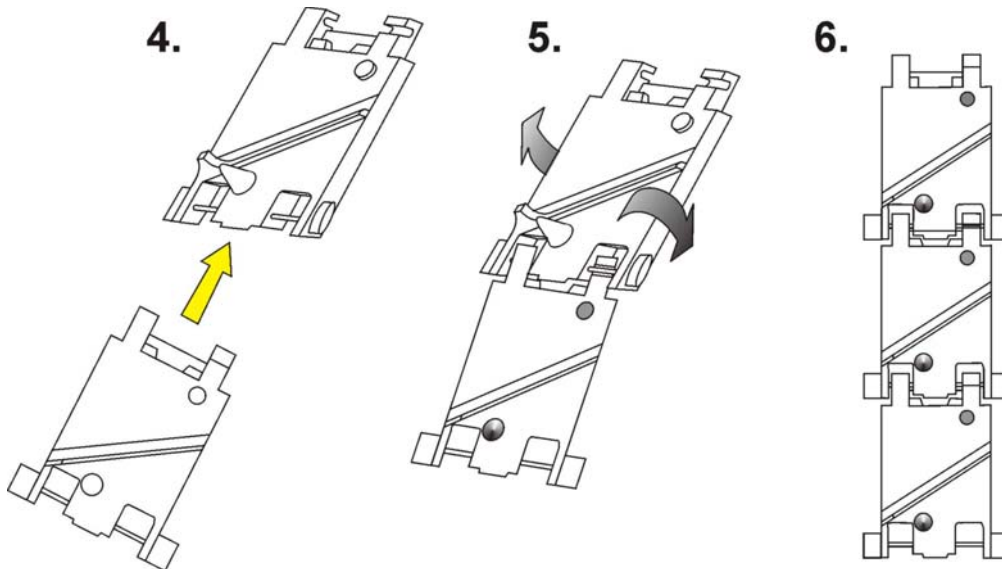

Figure 13: Track Plate assembly

10. Track Plate Replacement

1. The yellow shaded area, in Figure 14, is the 'track plate' guide path.

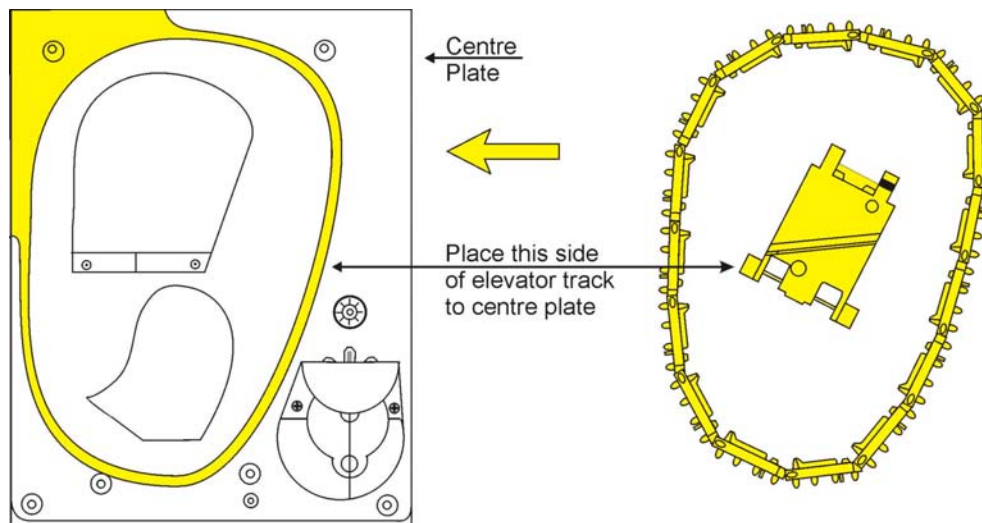

Figure 14: Track Plate positioning

2. Once the 'track plate' is in position, turn the track through 720° to ensure it is seated in the guide path correctly.

11. Final Drive Gear Replacement

1. Once the 'Elevator Track' is in place, the 'Final Drive Gear' can be fitted by placing the gear over its mounting spindle, while lining the teeth up with the secondary drive gear, adjust the 'Elevator Track' so that the gear falls into place. Figure 15.

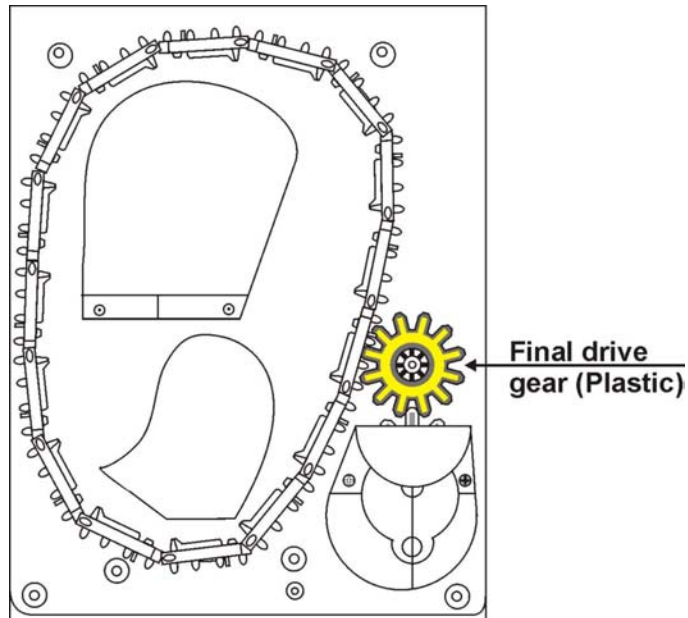

Figure 15: Final Drive Gear position

2. The end plate can now be re-fitted. See section 7.

12. Gear Box Cover Replacement

1. Remove the 'End Plate'. Section 7.
2. Remove the 'Elevator Track' & 'Final Drive Gear'. Section 8.
3. Unscrew the 2 gearbox cover screws & remove the cover. Figure 16.

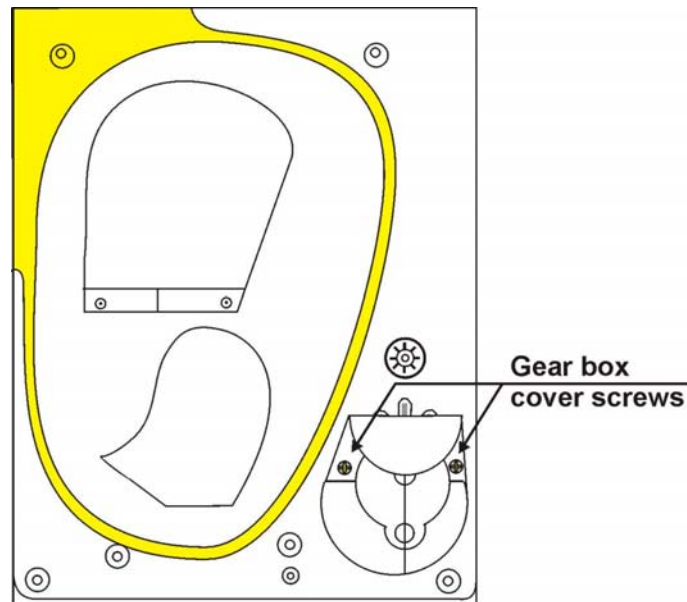

Figure 16: Gear Box Cover position

Access to the gears is now possible. See Section 13.

13. Gear Box Assembly

1. Remove the 'End Plate'. Section 7.
2. Remove the 'Elevator Track' & 'Final Drive Gear'. Section 8.
3. Remove the gearbox cover. Section 12.
4. Remove the gears in the order as shown in Figure 17.

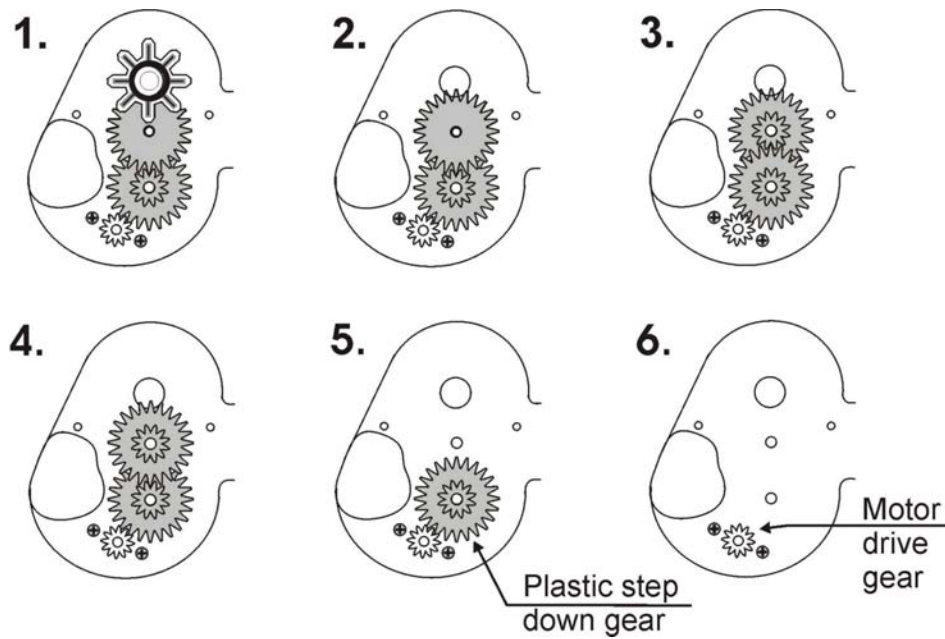

Figure 17: Gear Box Assembly

Access to the motor fixing screws is now possible.

5. To re-assemble, follow the above steps in reverse.

14. Motor Replacement

1. Remove the 'Coin Box'. Section 2.
2. Unsolder the red & black wires from the motor.

NOTE: The black wire connects to the terminal marked with a RED dot.

3. Remove the 'End Plate'. Section 7.
4. Remove the 'Track Plate' & 'Final Drive Gear. Section 8.
5. Remove the gearbox cover. Section 12.
6. Dismantle the gearbox. Section 13.
7. Unscrew the 2 motor fixing screws. Figure 18.

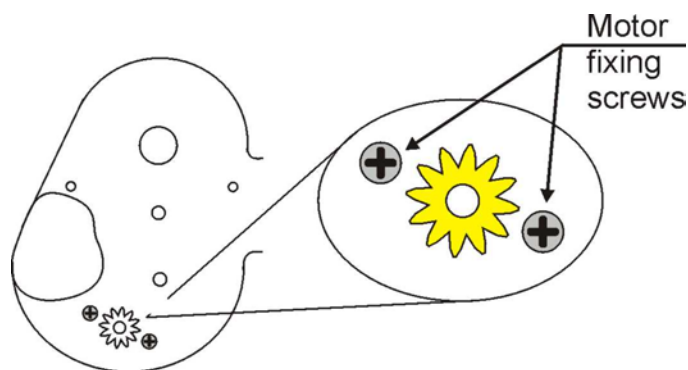

Figure 18: Motor screw positions

8. To re-assemble, follow the above steps in reverse.

15. Loom Replacement

1. Remove the 'Coin Box'. Section 2.
2. Unsolder the red & black wires from the motor.

NOTE: The black wire connects to the terminal marked with a RED dot.

3. Remove the 'End Plate'. Section 7.
4. Remove the 'Track Plate' & 'Final Drive Gear'. Section 8.
5. Remove CONN 2 from the 'Logic Board'. Section 6.

The loom can now be removed by pulling it through the 'Centre Plate' from the track side.

6. To replace the loom, follow the above steps in reverse.

16. Coin Box Assembly

1. Firstly, locate the 'Stirrer' in the 'Coin Box' as shown in Figure 19.

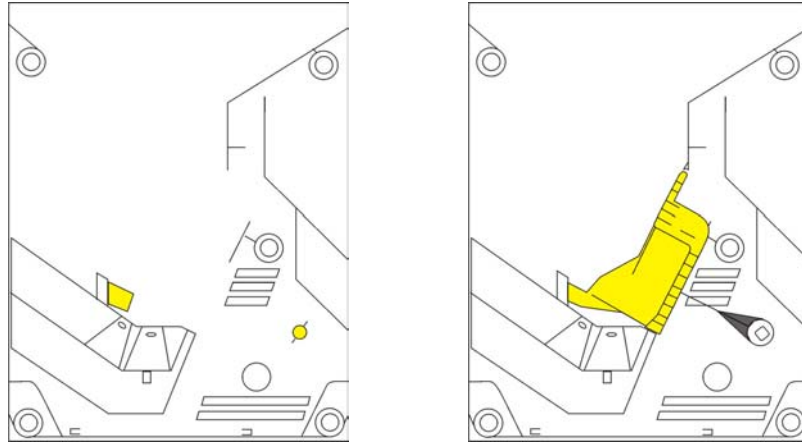

Figure 19: Stirrer position

2. Line up the 'Centre Plate' & 'Coin Box' as shown below. Figure 20.
3. Route the ribbon cable as shown in Figure 20.
4. Fit the 'Logic Board' into slots shown in Figure 20.
5. Feed the level sense wires through the slot shown in Figure 20.

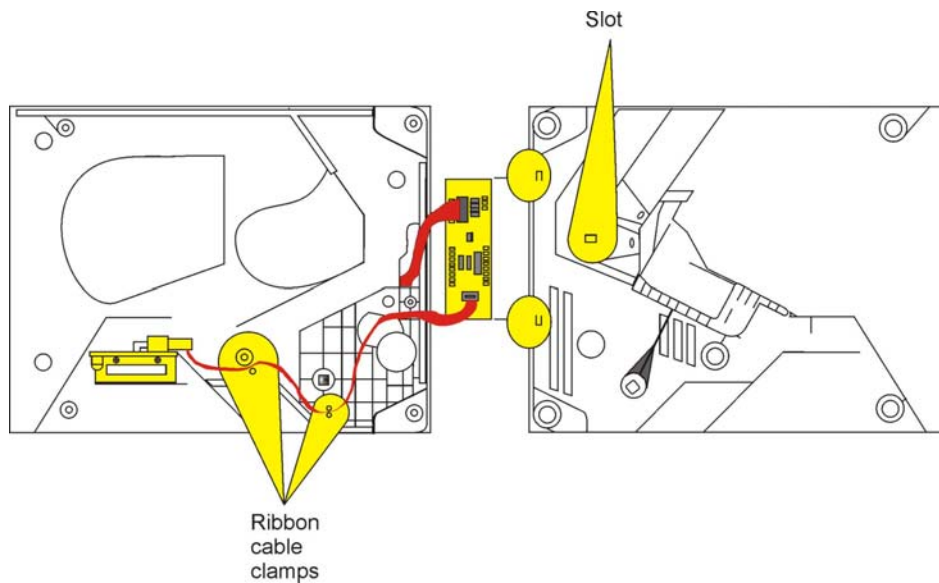

Figure 20: Coin Box Assembly 1

CONFIDENTIAL

Not to be disclosed without prior written permission from Money Controls

Page 20 of 22

6. Lift the 'Centre Plate' to meet the 'Coin Box'. Figure 21 & Figure 22.

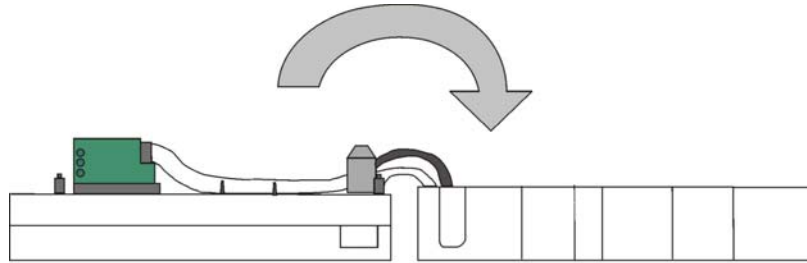

Figure 21: Coin Box Assembly 2

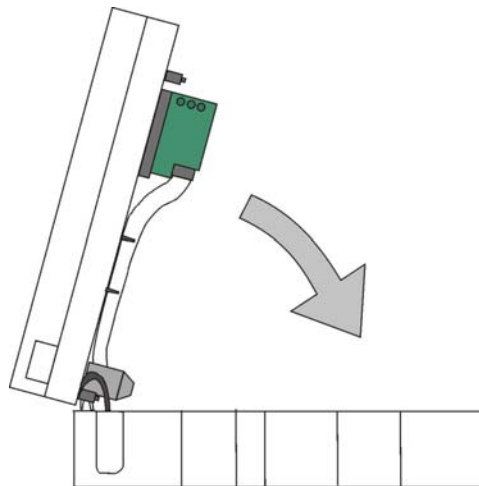

Figure 22: Coin Box Assembly 3

7. Align the 'centre plate' & 'coin box' & push together.
8. Turn the hopper over & refit the screws.
9. Refit the level sense wires.

This manual is intended only to assist the reader in the use of this product and therefore Money Controls shall not be liable for any loss or damage whatsoever arising from the use of any information or particulars in, or any incorrect use of the product. Money Controls reserve the right to change product specifications on any item without prior notice

CONFIDENTIAL

Not to be disclosed without prior written permission from Money Controls

Page 22 of 22